

pergola
solid
 sunbreaker 500

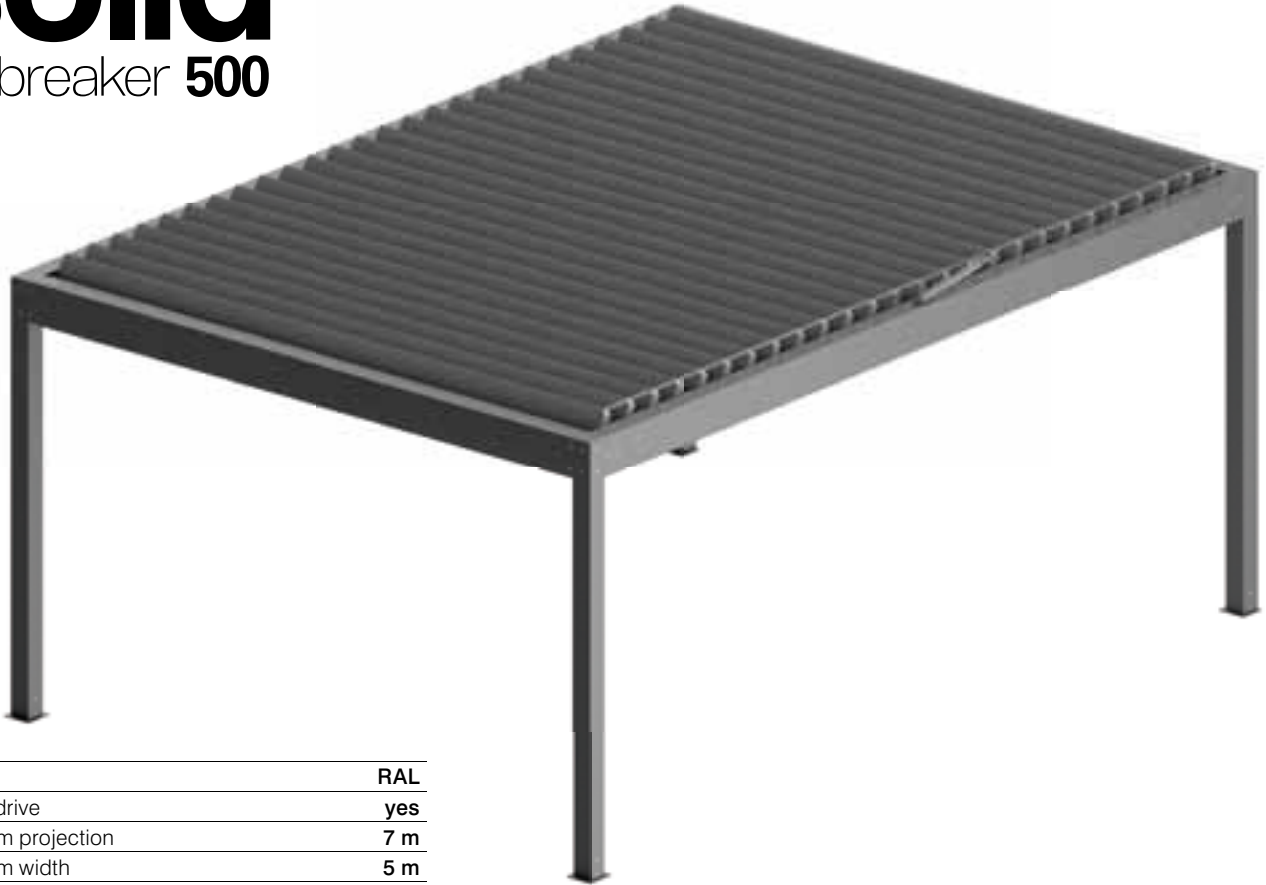

colour	RAL
electric drive	yes
maximum projection	7 m
maximum width	5 m
external use	yes
water drainage system	yes

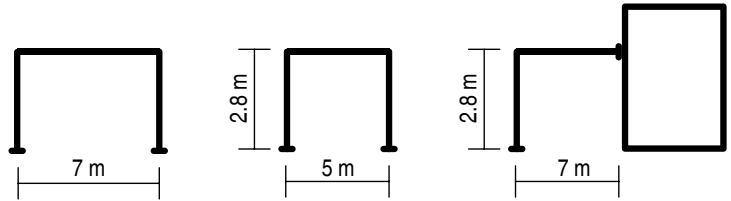

HOME MOTION by
somfy

somfy
 TaHoma

io
 homecontrol

RTS
 Radio Technology Somfy

LCN
 Local Control Network

SM
 STANDARD
 MOTOR INTERFACE

BBSA
 BRITISH BLIND & SHUTTER ASSOCIATION

sunicon
 sunicon

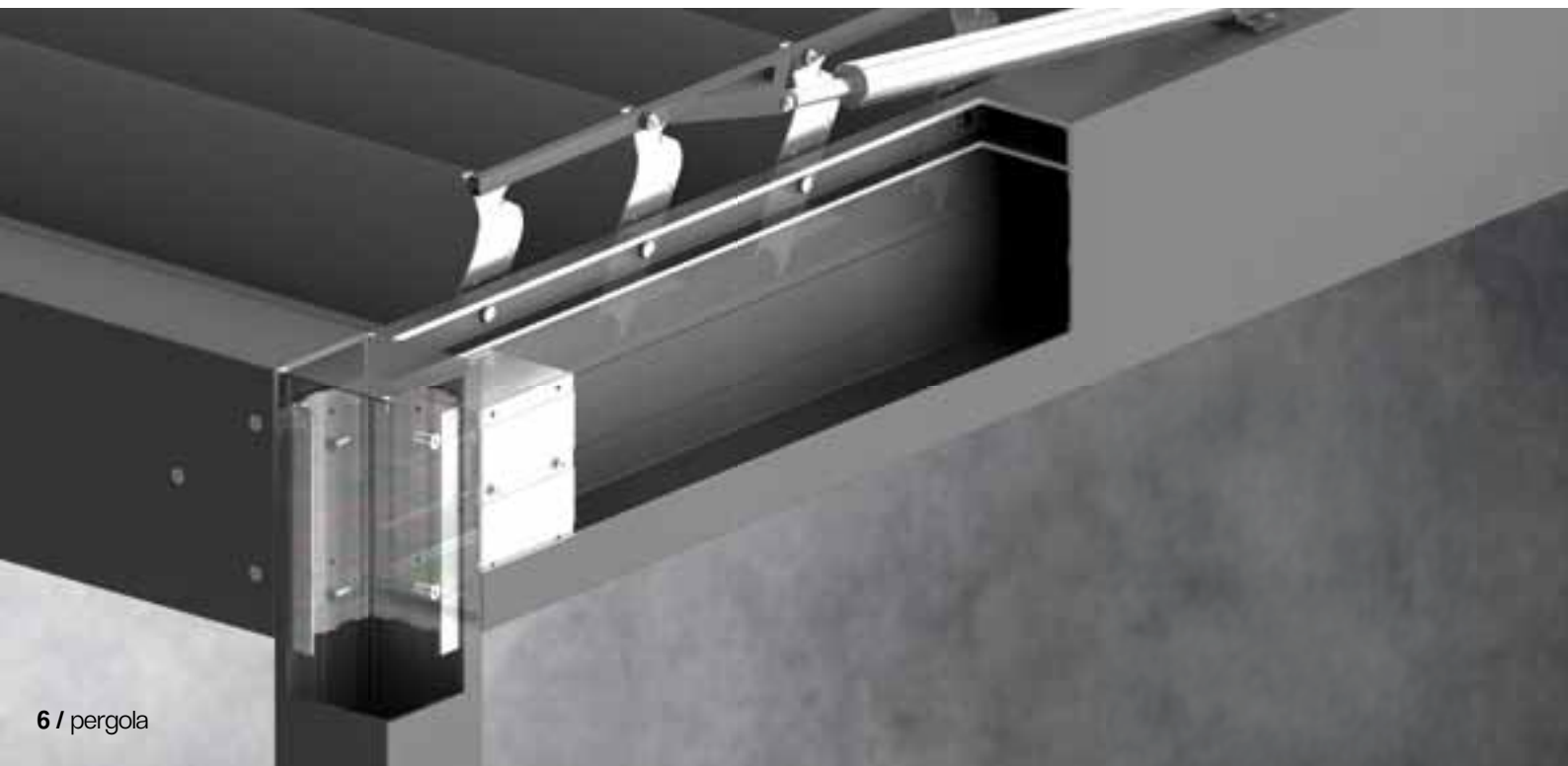



Properties:

- Extruded aluminium construction with stainless steel elements
- Water drainage system integrated with the construction
- Sun and waterproof system
- Construction and roofing painted in any RAL colour
- Roofing made from rotating slats
- Maximum dimensions of single module: 5 m width and 7 m projection
- Possibility of modular connection
- Possibility of wall-mounted and free-standing version
- Possibility of using a side panel system „SLIDE”
- Construction in accordance with EN 1090

pergola
solid
 sunbreaker 400



colour	RAL
electric drive	yes
maximum projection	7 m
maximum width	4 m
external use	yes
water drainage system	yes

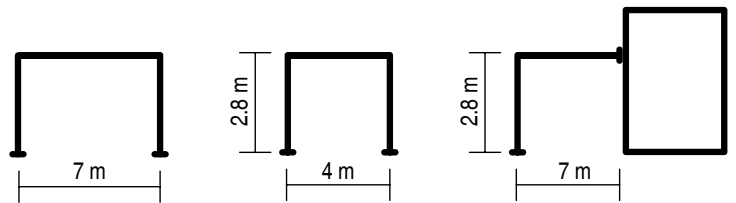

Pergola with projection over 5.2 m requires a middle pole supporting the construction.

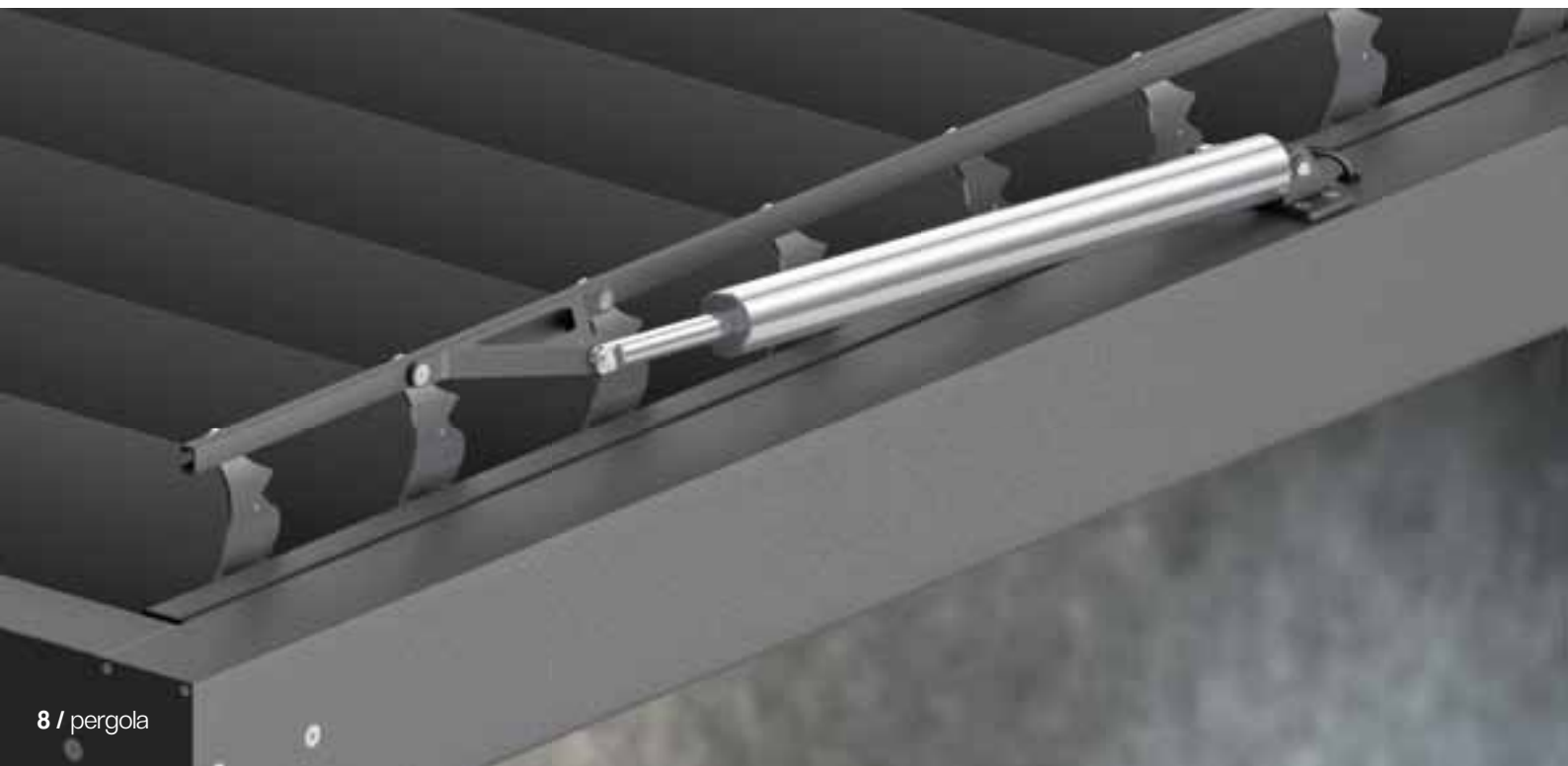



Properties:

- Extruded aluminium construction with stainless steel elements
- Water drainage system integrated with the construction
- Sun and waterproof system
- Possibility of using weather automation
- Construction and roofing painted in any RAL colour
- Roofing made from rotating slats
- Maximum dimensions of single module: 4m width and 7m projection
- Possibility of modular connection
- Construction in accordance with EN 1090

pergola solid

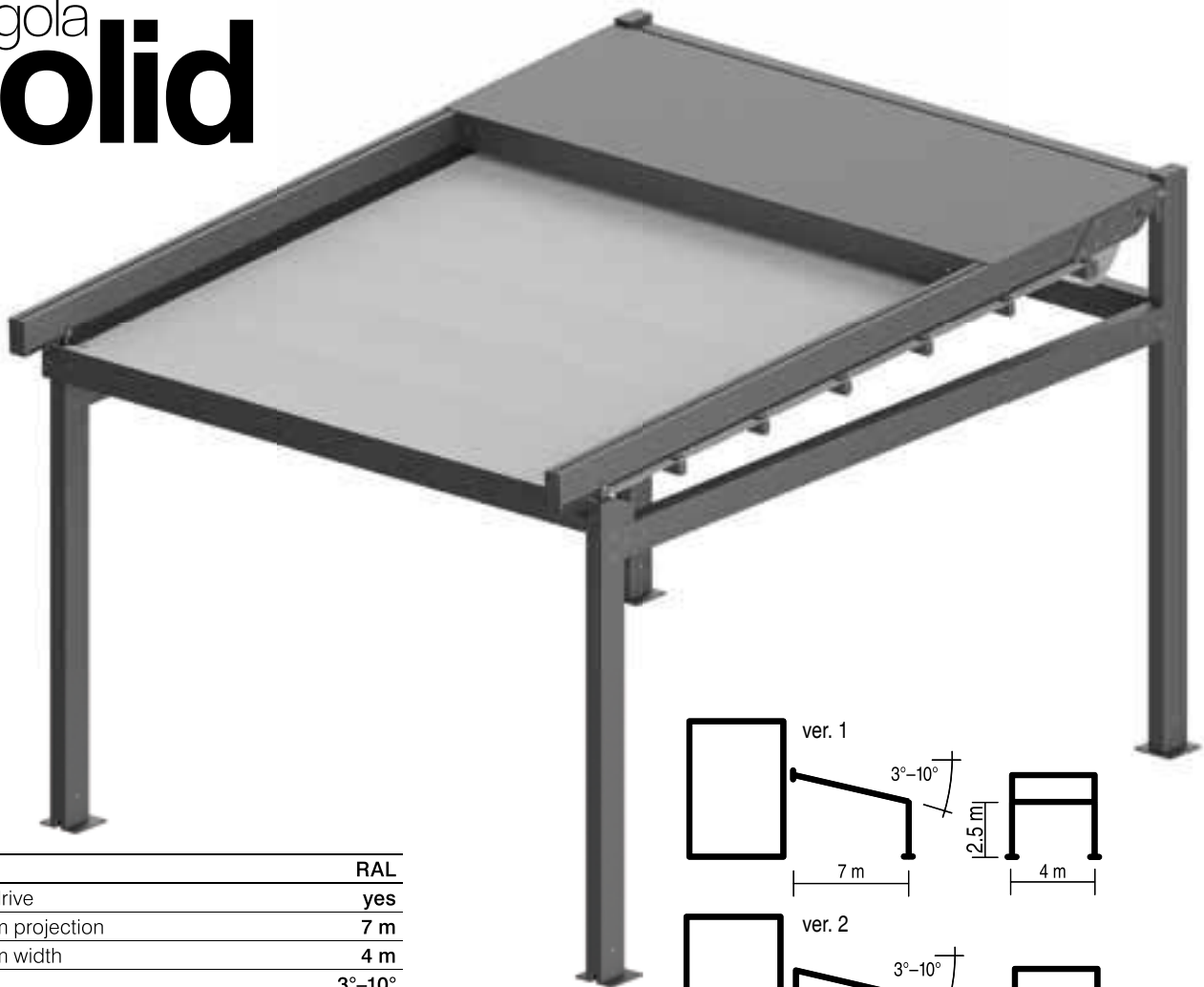

colour	RAL
electric drive	yes
maximum projection	7 m
maximum width	4 m
tilt angle	3°-10°
external use	yes
cover	PVC fabric dedicated for Solid system

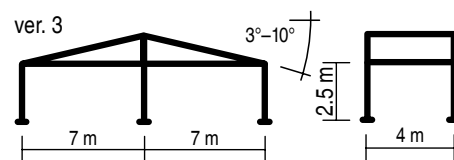
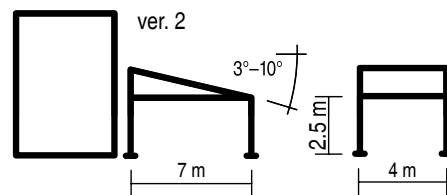
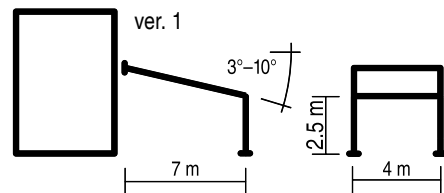

HOME MOTION by
somfy

somfy
TaHoma

io
homecontrol

RTS
Radio Technology Somfy

LCN
Low Cost Technology

SM
STANDARD
MOTOR INTERFACE

BBSA
BRITISH BLIND & SHUTTER ASSOCIATION

quintessence



Properties:

- Extruded aluminium construction with stainless steel elements
- Water drainage system integrated with the construction
- Sun and waterproof system
- Movable roofing operated electrically
- Possibility of using weather automation
- Optional LED lighting application
- Free-standing and wall-mounted version
- Construction painted in any RAL colour
- Maximum dimensions of single module: 4m width and 7m projection
- Possibility of modular connection
- Construction in accordance with EN 1090